

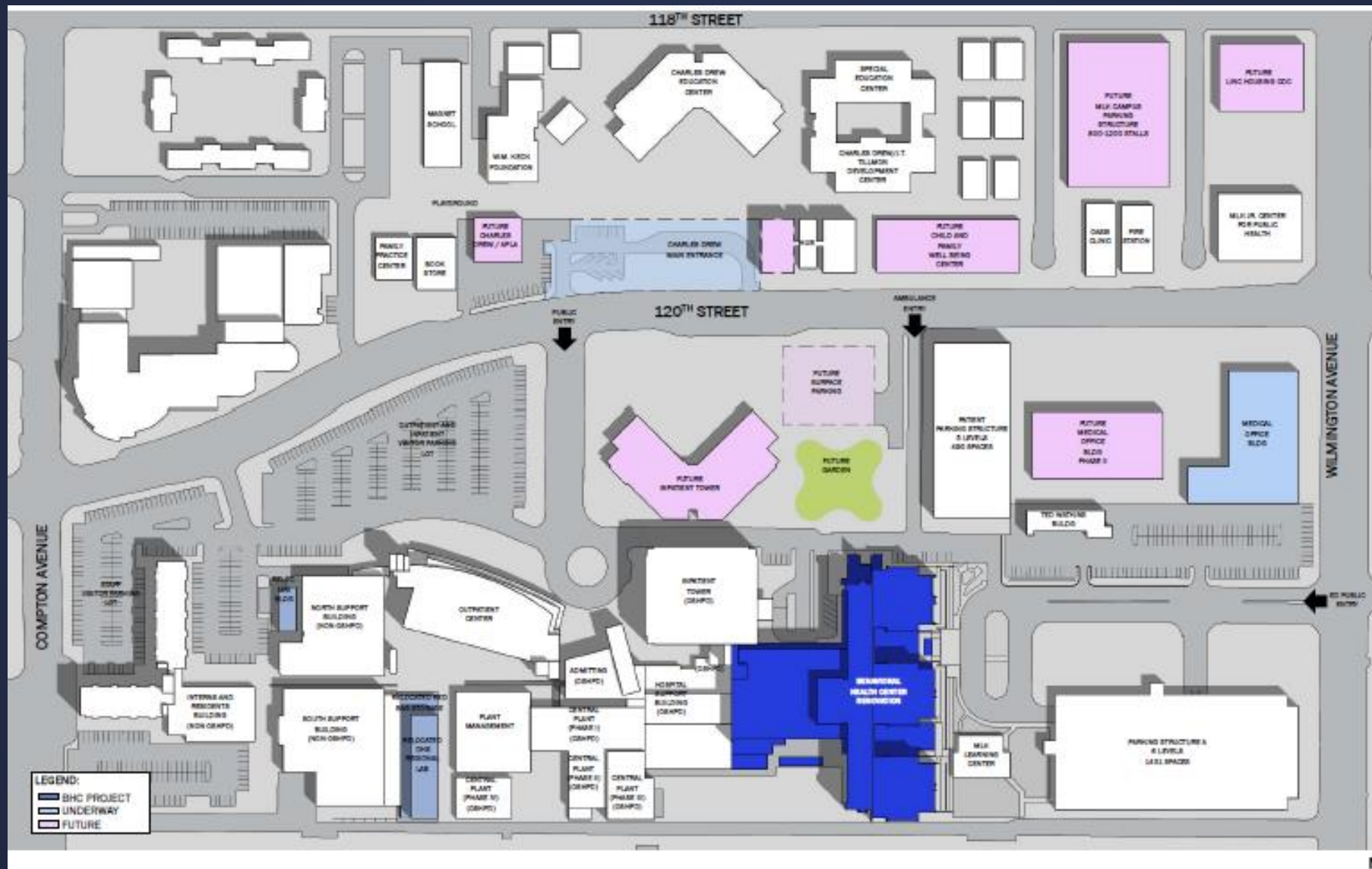

Martin Luther King, Jr. Medical Campus

A Continuum of Care in Willowbrook

MLK Campus Plan



Campus Overview

- The Martin Luther King, Jr. Medical Campus (MLK Medical Campus) is providing Willowbrook and surrounding communities with a physical and behavioral health continuum of care.
- The campus is comprised of:
 - MLK Community Hospital
 - MLK Outpatient Center
 - Augustus Hawkins Mental Health Center
 - MLK Mental Health Urgent Care Center (will be moving to the future MLK Behavioral Health Center in 2021)
 - MLK Recuperative Care Center
 - Center for Public Health
 - Future MLK Behavioral Health Center
 - Future MLK Child and Family and Wellbeing Center



Future MLK Behavioral Health Center

- The MLK BHC will be a resource hub for a continuum of care that will deliver treatment and wraparound services in one location.
- It will be the first facility of its kind, envisioned to provide integrated inpatient, outpatient and supportive services for some of Los Angeles County's most vulnerable populations, including those struggling with mental illness, substance use disorders and homelessness, and those who have been involved in the criminal justice system.
- Phase I will be open in late 2020 and completion will be in late 2021.