

DEPARTMENT OF HEALTH SERVICES

714/744 P STREET

P.O. BOX 942732

SACRAMENTO, CA 94234-7320

June 28, 1994



(916) 657-2941

TO: All County Welfare Directors
All County Administrative Officers
All County Medi-Cal Program Specialists/Liaisons

Letter No.: 94-54

ERRATA TO ALL COUNTY WELFARE DIRECTORS LETTER (ACWDL) NO.: 94-44

The purpose of this errata notice is to inform you that the location has changed for the training site in Fresno County on the revised/new Medi-Cal Eligibility Manual procedures on disability.

ACWDL No. 94-44 indicated that the July 8, 1994 training in Fresno County would be held at:

Manchester Center Mall, Second Floor, Hospitality Room
Corner of Shields and Blackstone Avenues
Fresno

The new location, those counties affected and maps to the facility follow:

FRESNO	Fresno	Merced
	Inyo	Mono
Date: July 8	Kern	San Luis Obispo
	Kings	Stanislaus
	Madera	Tulare
	Mariposa	

Address: Department of Social Services
Barton Building
4499 E. Kings Canyon Avenue
(The entrance to the building is actually on Barton Avenue)

Contact: Terry Castro, Fresno County, (209) 935-2058

If you have any questions, please contact either Ms. RaNae Dunne at (916) 657-0714 or Ms. Marie Taketa at (916) 657-1250.

Sincerely,

ORIGINAL SIGNED BY

Frank S. Martucci, Chief
Medi-Cal Eligibility Branch

Enclosures

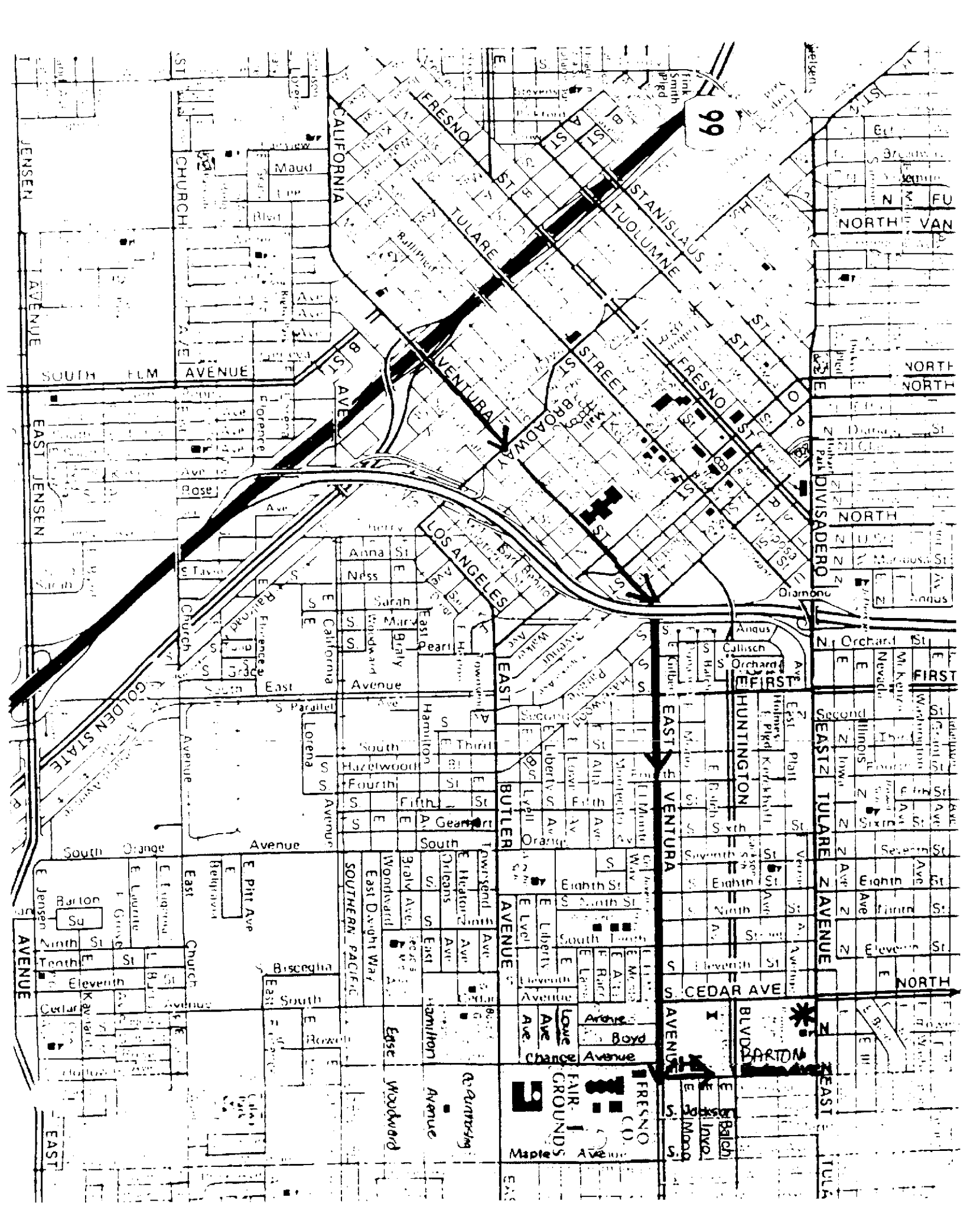

FRESNO COUNTY DEPARTMENT OF SOCIAL SERVICES/VMC COMPLEX

ROOSEVELT HIGH SCHOOL CAMPUS

EAST HUNTINGTON BOULEVARD

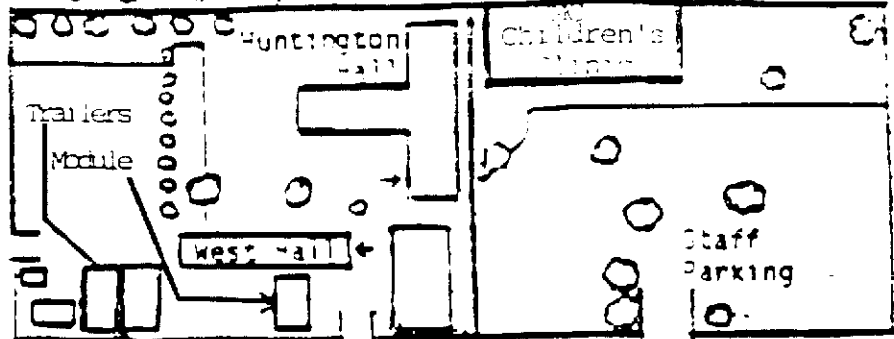

EAST INYO AVENUE

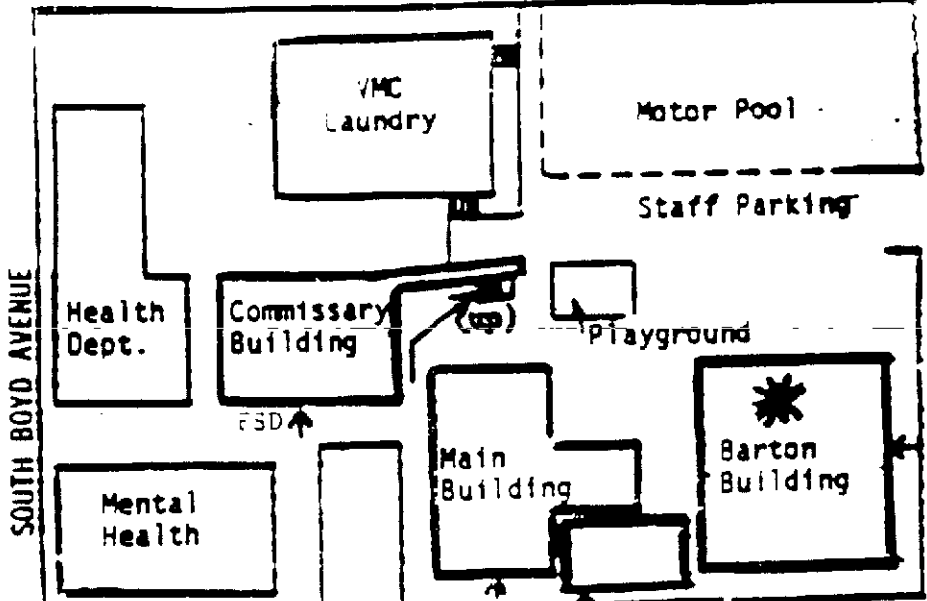

EAST MONO AVENUE

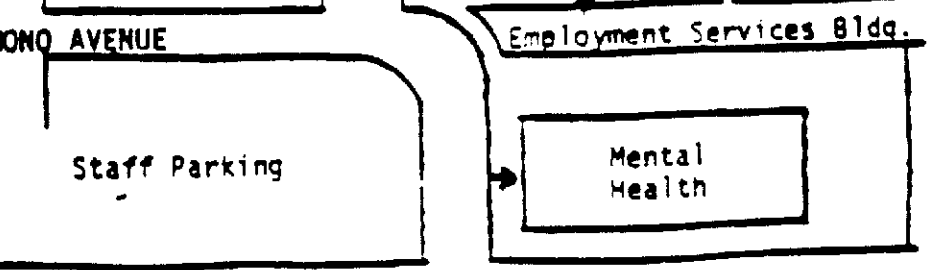

EAST KINGS CANYON ROAD

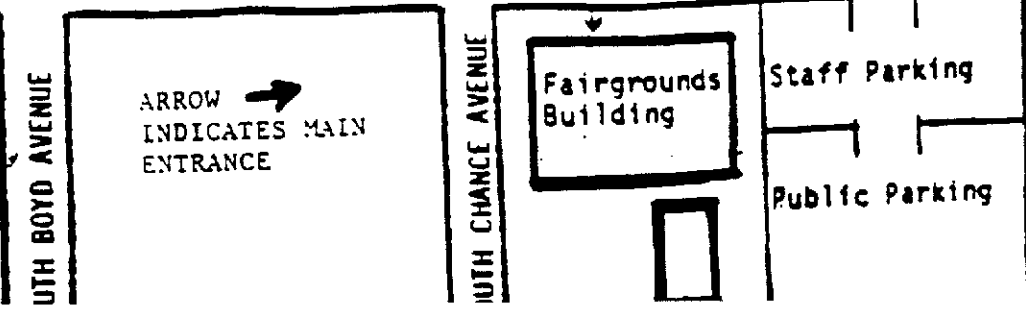

ARROW INDICATES MAIN ENTRANCE

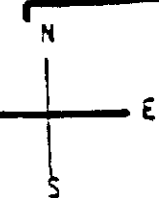

SOUTH CEDAR AVENUE

SOUTH BOYD AVENUE

SOUTH BARTON AVENUE

UTH ARCHIE AVENUE

UTH BOYD AVENUE

UTH CHANCE AVENUE

VMC MEDICAL INTAKE
2ND FLOOR IN WING

VMC North

VMC

VMC

Health Dept.

Commissary Building

Mental Health

Main Building

Barton Building

Employment Services Bldg.

Mental Health

Fairgrounds Building

Staff Parking

Public Parking